

DO NOT SCALE
 0 10 100
 Millimetres

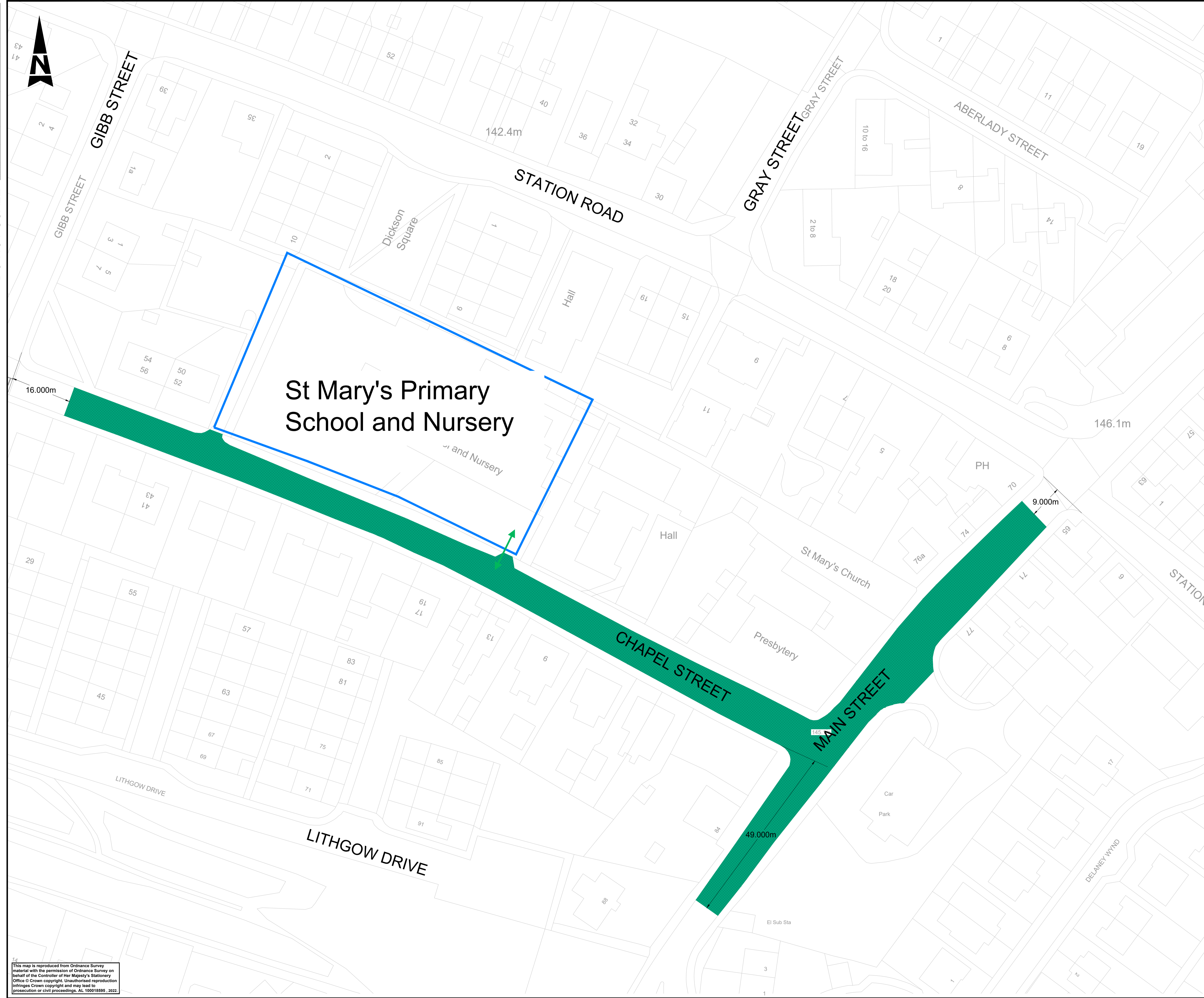
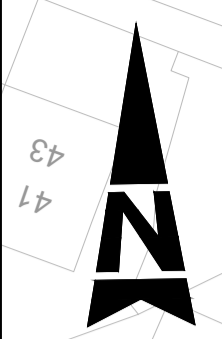

St Mary's Primary
 School and Nursery

- NOTES**
3. THIS DRAWING IS NOT FOR CONSTRUCTION.
 4. ALL DIMENSIONS ARE IN METRES UNLESS NOTED OTHERWISE.
 5. DO NOT SCALE FROM THIS DRAWING.
 6. THIS DRAWING IS BASED UPON ORDNANCE SURVEY MAPPING PROVIDED BY NORTH LANARKSHIRE COUNCIL, REPRODUCED BY PERMISSION OF ORDNANCE SURVEY ON BEHALF OF HMSO © CROWN COPYRIGHT AND DATABASE RIGHT 2022. ALL RIGHTS RESERVED.
 7. WORKS AREAS IDENTIFIED VIA VISUAL WALKOVER SURVEY AND AS SUCH SHOULD BE TAKEN AS PROVISIONAL.
 8. THIS DRAWING IS TO BE READ IN CONJUNCTION WITH ALL RELEVANT DRAWINGS AND DOCUMENTS ASSOCIATED WITH THIS PROJECT.
 9. FOR SIGN DETAILS, PLEASE REFER TO DRAWING NUMBER 5215295-ATK-HSN-XX-DR-CH-000101.

- KEY**
- PROPOSED 20mph SPEED LIMIT EXTENTS
 - SCHOOL BOUNDARY
 - SCHOOL ACCESS POINT

Description	Status	Revision	Drawn	Checked	Reviewed	Authorised	Issue Date

ISSUE FOR CONSULTATION

Status	Revision	Drawn	Checked	Reviewed	Authorised	Issue Date
S0	P01.1	---	---	---	---	---

Drawing Suitability: **FOR CONSULTATION** Status: **S0**

2 Atlantic Square
 York Street
 Glasgow
 Scotland
 G2 8JQ
 Tel: +44 (0)141 220 2000
 Fax: +44 (0)141 220 2001
 Copyright © SNC Lavalin (2022) www.atkinsglobal.com



Project Title: **NLC PART TIME
 20mph SPEED LIMITS AT SCHOOLS**

Drawing Title: **SITE 37 - ST MARY'S
 PRIMARY SCHOOL AND NURSERY
 SIGNAGE AND TRO GENERAL LAYOUT**

Drawing Number	Project	Originator	Volume
5215295	XX	ATK	HSN
		- DR - CH - 000037	
Location	Type	Role	Number
A1	NTS	1 of 1	Rev: P01.1

This map is reproduced from Ordnance Survey material with the permission of Ordnance Survey on behalf of the Controller of Her Majesty's Stationery Office © Crown copyright. Unauthorised reproduction infringes Crown copyright and may lead to prosecution or civil proceedings. AL 100018995, 2022