



STATION ROAD

19

PO

8

4

2

177

PROPOSED BAY
EXISTING BAY
DISABLED
DISABLED



NORTH LANARKSHIRE COUNCIL

Enterprise & Communities
Infrastructure and Transportation
Transportation Engineering

Reproduced by permission of Ordnance Survey
on behalf of HMSO. © Crown copyright and
database right 2021.
All rights reserved. Ordnance Survey Licence
number 100023396

REV	DESCRIPTION	DRAWN BY	CHECKED	DATE

PROJECT TITLE
Disabled Person's Parking Place

DRAWING TITLE
Proposed Disabled Bay Location
Immediately in front of
8 Station Road
Stepps

DRAWN BY
BA

SCALE
NTS

DRAWING NUMBER
TMS064/2454

DATE DRAWN
4-04-2022

CHECKED BY
JS

APPROVED BY
JS

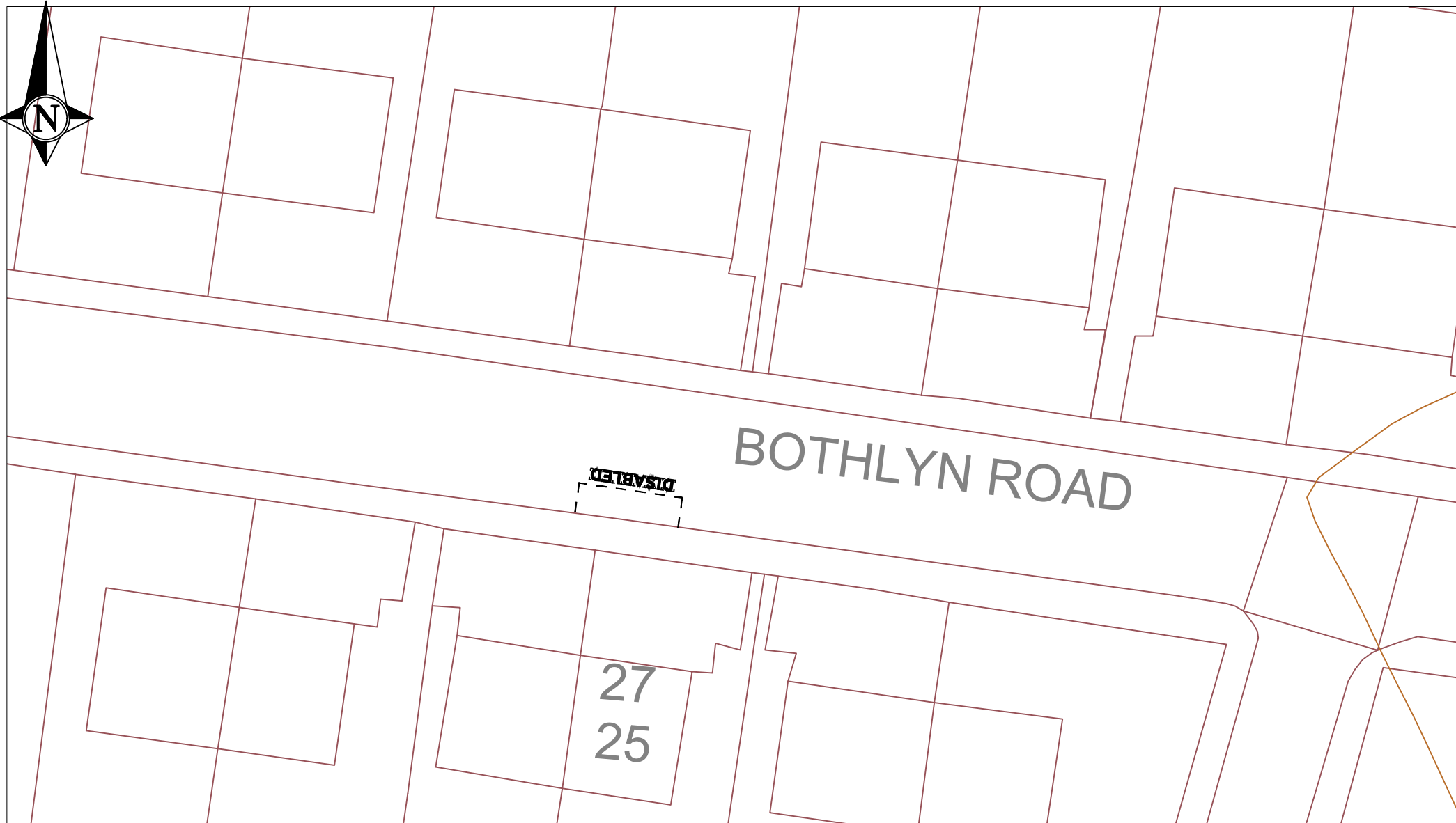

NORTH LANARKSHIRE COUNCIL
Enterprise & Communities
Infrastructure and Transportation
Transportation Engineering

Reproduced by permission of Ordnance Survey
on behalf of HMSO. © Crown copyright and
database right 2021.
All rights reserved. Ordnance Survey Licence
number 100023396

REV	DESCRIPTION	DRAWN BY	CHECKED	DATE

PROJECT TITLE	Disabled Person's Parking Place
DRAWING TITLE	Proposed Disabled Bay Location Immediately in front of 25-27 Bothlyn Road Stepps

DRAWN BY BA	DATE DRAWN 4-04-2022
SCALE NTS	CHECKED BY JS
DRAWING NUMBER TMS064/2462	APPROVED BY JS

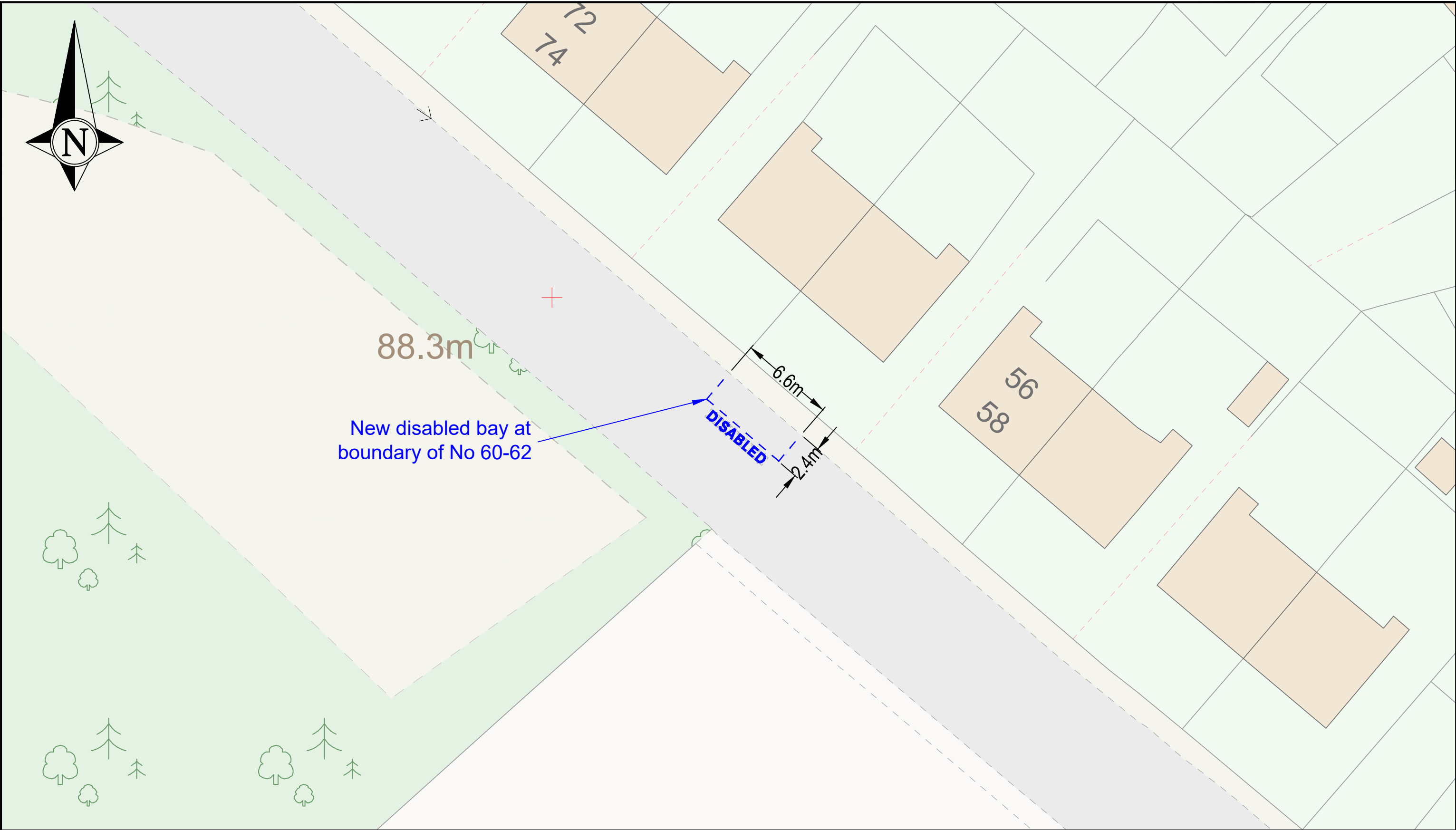

NORTH LANARKSHIRE COUNCIL
Enterprise & Communities
Infrastructure and Transportation
Transportation Engineering

Reproduced by permission of Ordnance Survey
on behalf of HMSO. © Crown copyright
and database right 2024.
All rights reserved. Ordnance Survey
Licence number **AC0000819817**

REV	DESCRIPTION	DRWN	CHKD	DATE

PROJECT TITLE
RT-23-062 Signing & Lining Contract
DRAWING TITLE
60-62 Station Road Millerston

DRAWN BY CM	DATE DRAWN 03.12.24
SCALE NTS	CHECKED BY
DRAWING NUMBER	APPROVED BY