



# Public Consultation Meeting

Relocation of Portland School and Fallside School  
to the Mavisbank Campus

9 December 2025

Chapelside Community Centre

**LIVE  
LEARN  
WORK  
INVEST  
VISIT**

**Proposal to relocate Portland High School and  
Fallside High School to the existing Mavisbank  
School. Providing one campus for both schools.**



- **Public Meeting:  
9 December 2025  
Chapelside  
Community Centre  
6-8pm**

# Purpose of Meeting

To outline the  
proposal via  
presentation

To answer  
questions  
regarding the  
proposal

To gather  
comments and  
views on the  
proposal

# Consultation Timeline

This proposal is subject to statutory consultation over a period of 56 days that include 30 school days

## Period of Consultation

- 24<sup>th</sup> November 2025 – 19<sup>th</sup> January 2026
- Consultation documents issued to stakeholders and made available on Council website at:  
<http://www.northlanarkshire.gov.uk/your-community/working-communities/consultations/live-consultations>

# Proposals

Proposal to relocate Portland High School and Fallside High School to the existing Mavisbank site. Providing one campus for both schools.

There are reasons for this proposal.....

# Reasons for Proposal

Expand opportunities for wider learning experiences and outcomes for Children and Young People

Provide an equitable service to children with Social, Emotional and Behavioural Needs in North Lanarkshire

Foster inclusion by encouraging positive peer relationships and reducing social isolation

Provide modern facilities that are fit for purpose with safe spaces to reduce anxiety, improve focus and create a welcoming atmosphere

Strengthen leadership, along with greater depth and breadth of staffing and a shared sense of purpose

Allow for more rigorous quality assurance to support the implementation of consistent high standards and improved outcomes for Children and Young People

# The Existing Site: Portland School





# The Existing Site: Fallside School





# The New Site: Mavisbank School



# Mavisbank Floor Plan (current)

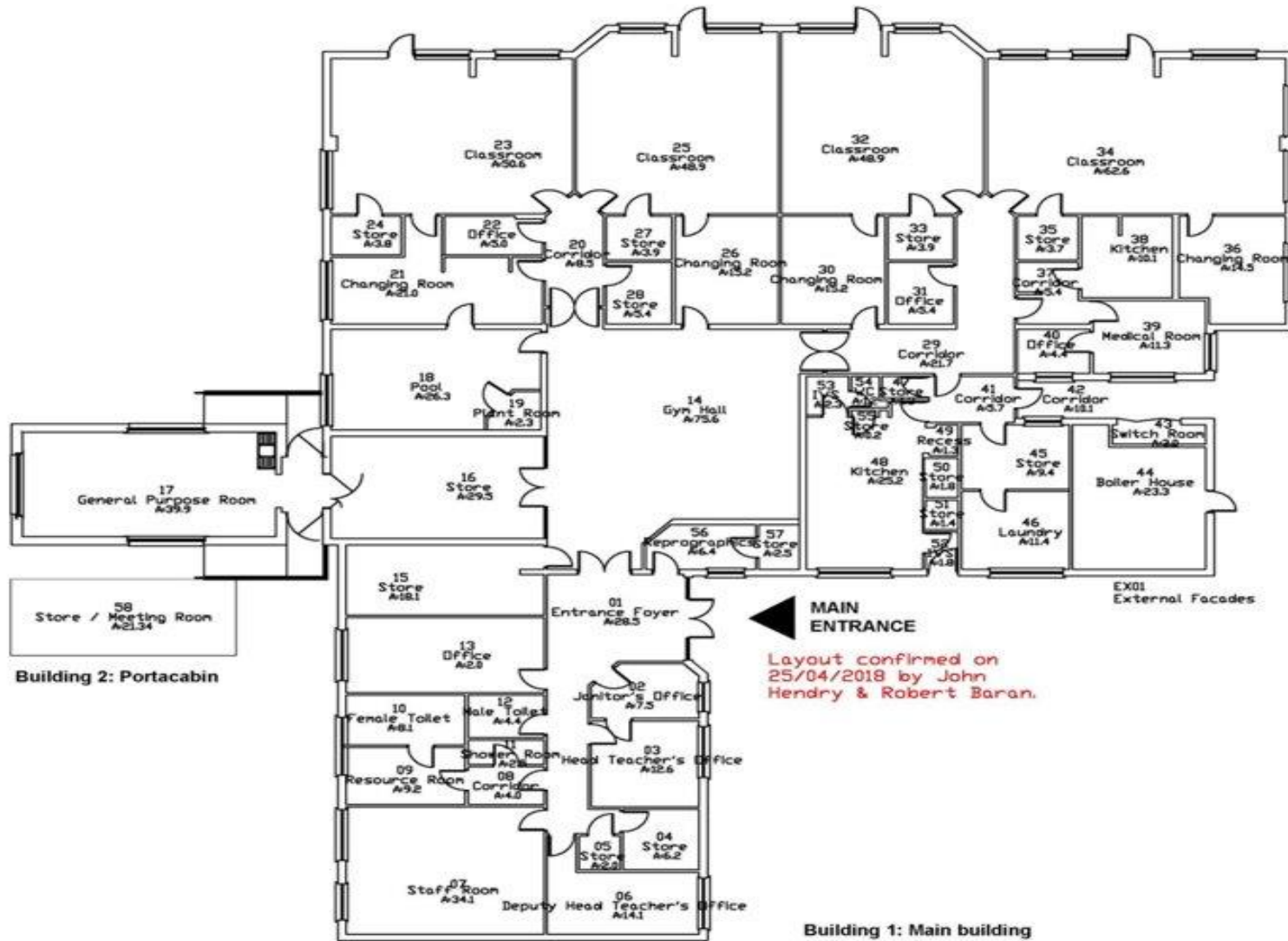

# Why move?

Portland & Fallside Schools:

\*Suitability Score

D

Older building requiring significant investment to bring up to date

Day to day running costs not sustainable

No direct access to natural outdoor areas

Mavisbank School:

\*Suitability Score

B

Small cosmetic works required to provide improvements

Provision of appropriate sensory facilities

Direct access to natural outdoor areas

# Learning Environment

New Campus – Mavisbank School Site:

\*Suitability Score **B**

- Flexible curriculum and vocational spaces
- Direct access to natural outdoor and sensory areas
- Digital learning environment
- Physical recreation facilities
- Sensory and retreat spaces

# Implications of the proposals

## The school community

- Transitioning pupils as seamlessly as possible: Enhanced transition for all pupils through group activities and individualised bespoke arrangements in accordance with pupils' needs.
- Transitioning staff using the appropriate workforce change policies and in consultation with Trade Unions.

## Wider community

- Relocation and provision of space for external stakeholders: discussions with community groups and visiting services to plan effectively for use of shared spaces.

# Educational Benefits Statement

Senior Leadership & staff teams will have increased opportunities for joint planning to improve pedagogy and measure impact

The curriculum offer will provide greater breadth and depth including increased vocational opportunities supported by partner agencies

Digital resources for learning will allow for a broader curriculum offer and range of tailored teaching approaches

The facilities across the campus will be designed to support and enhance positive mental health and wellbeing of staff and pupils

Child Centred approach with a focus on the UNCRC Article 3 & 29  
[convention-rights-child-text-child-friendly-version.pdf](#)

Inclusive and welcoming environment to foster effective partnership working and improve outcomes for children, young people and their families

# Educational Benefits Statement

Increased opportunities for flexible support strategies to enhance a needs driven, collaborative approach to meet the specific emotional and behavioural needs of individual pupils

Bespoke resources to support a solution focused approach to meet the individual needs of the young people on the campus

Increased opportunity to strengthen transition supports at key stages of transition keeping the emotional wellbeing of the young people at the centre of good practice

A greater sense of shared school community with young people from both schools participating in a broad range of opportunities supporting them with personal and wider achievement

Strengthen flexibility of GIRFEC practices and integrated working to ensure a needs driven approach for children and young people that aligns with their assessment and wellbeing plan

Reduction in social isolation by providing greater opportunity to develop positive peer relationships across the campus



# Educational Benefits Statement

Collaboration across both schools to support shared responsibilities for school improvement and professional planning across the campus

Increased opportunities for professional learning and sharing good practice

Wider opportunities for vocational learning improving positive destination outcomes and post school pathways for school leavers

Improved outdoor space for learning and extra-curricular experiences

Sustainable environment and carbon impact will be considered across the campus

# Statutory Consultation Process

Consultation period  
closes on  
19<sup>th</sup> January 2026

Education Scotland  
(ES) sends its  
report on its  
findings by 12  
February 2026

Council publishes  
Final Outcome  
Report including ES  
Report 5 March  
2026

After a further period  
of reflection, the  
Council makes a  
formal decision on  
the proposal

# Have Your Say

The Statutory Consultation provides an opportunity for all stakeholders to become informed about the proposal and to make their views known by email to:  
[ef.fallsideandportland@northlan.gov.uk](mailto:ef.fallsideandportland@northlan.gov.uk)

Website address  
<http://www.northlanarkshire.gov.uk/your-community/working-communities/consultations/live-consultations>

and/or in writing to the Council at:

School Consultations -  
Education & Families,  
2<sup>nd</sup> Floor, Civic Square  
Windmillhill Street,  
Motherwell, ML1 1AB;

Questions that have  
arisen so far during the  
consultation

Questions you would like  
to ask today